

# State of Wyoming Corner Record

(In compliance with the *CORNER PERPETUATION AND FILING ACT*, Wyoming Statutes, 1977, Section 36-11-101, et. seq., and the Rules and Regulations of the Board of Registration for Professional Engineers and Professional Land Surveyors)

Reverse side of this form may be used if more space is needed.

Record of original survey and citation of source of historical information (if corner is lost or obliterated). Description of corner monumentation evidence found and/or monument and accessories established to perpetuate the location of this corner. Sketch of relative location of monument, accessories, and reference points with course and distance to adjacent corner(s) (if determined in this survey). Method and rationale for reestablishment of lost or obliterated corner.  
 Township 14 North, Range 64 West, Sixth Principal Meridian

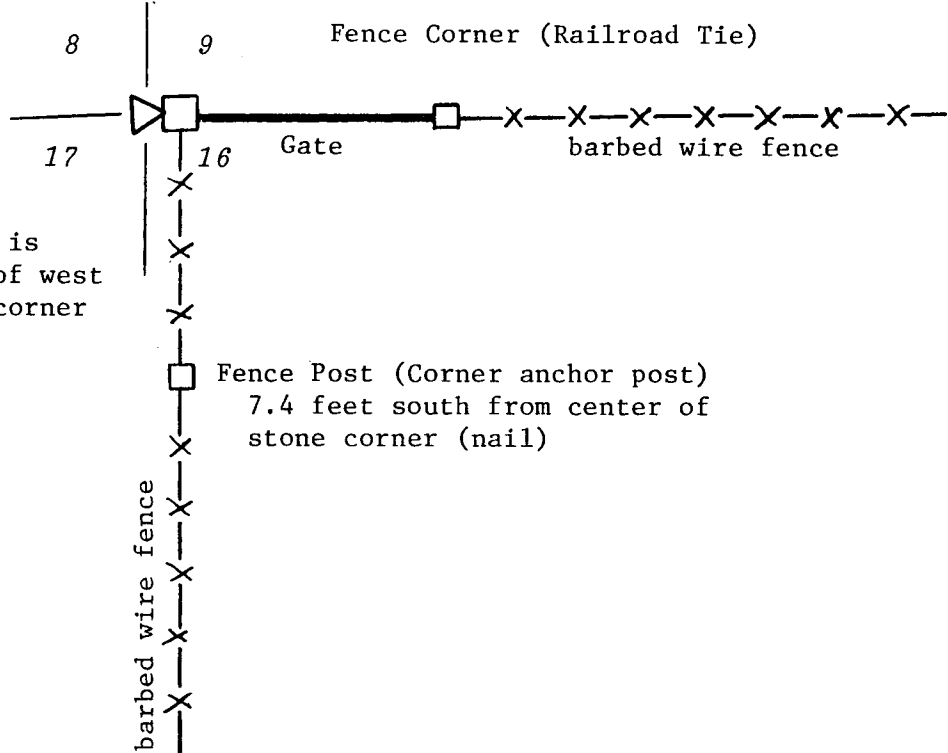

Stone monument is 0.5 foot west of west side of fence corner post.

Fence Post (Corner anchor post)  
7.4 feet south from center of stone corner (nail)



216832  
 LARAMIE COUNTY CLERK  
 CHEYENNE, WY.  
 '98 JAN 15 AM 8 47

The section corner monument is a stone 0.4 ft. x 0.5 ft. x 1.5 ft. The monument has four horizontal scribe marks on both the east and south faces. The stone is pink sandstone, and its physical dimensions and coloration agree with the original field notes.

Witnesses: Larry T. Perry, PLS 3047  
 Gary N. Grigsby

Date of Field Work: 5 September 1997 Office Reference: \_\_\_\_\_

### CROSS INDEX DIAGRAM

A	1	2	3	4	5	6	7	8	9	10	11	12	13	14	15	16	17	18	19	20	21	22	23	24	25
B																									
C																									
D																									
E																									
F																									
G																									
H																									
J																									
K																									
L																									
M																									
N																									
O																									
P																									
Q																									
R																									
S																									
T																									
U																									
V																									
W																									
X																									
Y																									
Z																									

Firm/Agency, Address  
Dr. H.W. Stoughton, PE, PLS  
Geodetic Engineer  
2821 Carey Avenue  
Cheyenne, Wyoming 82001  
Telephone Number: (307) 632-7460  
Wyoming P.E. & P.L.S. No. 3723

This corner record was prepared by me or under my direction and supervision.  
**SEAL & SIGNATURE**

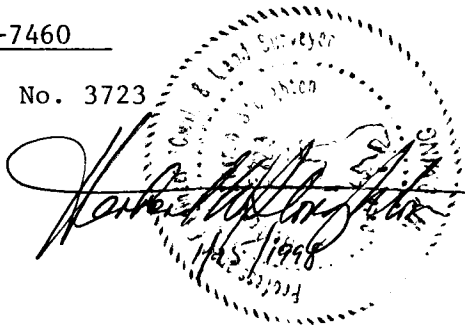

(8, 9, 16, 17)

Corner Name: J - 9 Section: T 14 R 64 6th P.M. Cross-Index No.: \_\_\_\_\_

SBRPEPLS/PLSW: March 1994

**BOOK 1470**

**0156**